

Clone or Extend to TV or other screen

Clone or extend, what is the difference?

Clone/Duplicate as suggested, makes a copy of what is on one screen and displays the same onto another screen.

Extend allows you to keep your screen and the other screen as one large screen. With practice, you can use your computer/laptop's screen and visible to you only, while your class is watching Youtube on the extended part of your screen.

If you extend your screen, you will need to **Restore Down** the window you want to place on the second screen. Do not minimise your window and do not maximise your window before moving to the other screen. Once moved, maximise your screen.

Note: If you cannot see **Extend** or **Clone**, then either your computer is:

- Not connected to a second screen OR
- The second screen is not turned on OR
- Your computer/laptop has a problem and you will need to log a job.

Quickest way to Clone or Extend (Windows 10 only)

Hold down the **Windows key**, (*little flag type thing, generally second key bottom left*) and press the letter **P** on your keyboard and you will get the following image to choose from. **Image (1) example**

Image (1) example

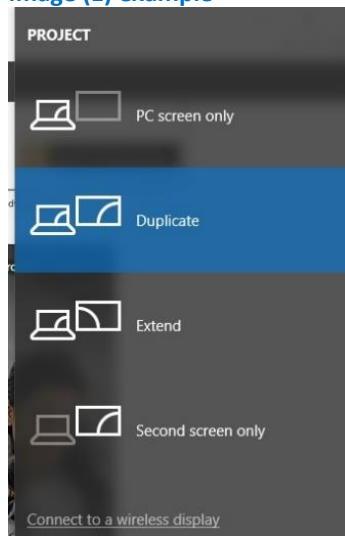
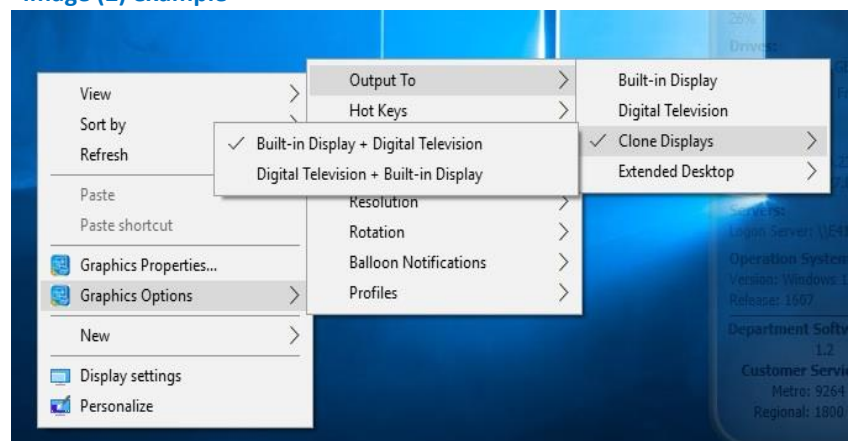

Image (2) example



Another way to set Clone or extend, please read on.

Clone/Extend other example:

Point to the middle of the screen, away from any icons, and click once with your right mouse button.

Move to **Graphic Options** then **Output To**, and select **Clone Displays** You will want to select **Built-in-Display + Digital Television**, this makes your main screen that you type to, appear on your computer/laptop's screen. **Image (2) example**